

Index to section “A” Policies

Index A 1
 Telephone Directory A 1
 Definitions..... A 2
 General Policies A 3
 Delivery Policies A 3
 Warranty Information A 5
 Order Entry Policy A 7
 Service Orders..... A 8
 Cabinet Code Definitions..... A 9
 Custom Charges A 10
 Cabinet Line Descriptions A 12
 Canadiana Cabinet Line..... A 13
 Excellence Cabinet Line A 14
 Country Classic Cabinet Line..... A 15
 Avonlea Cabinet Line A 16
 Warranty A 17
 Commercial Warranty..... A 18
 Warranty Waiver..... A 19

General Inquiries..... (705) 808-1038
..... inquiries@canadianacabinets.com

Sales &

Customer Service..... (705) 243-7871

Order Submissions orders@canadianacabinets.com

Fax..... (866) 376-4316



(705) 243-7871 Customer Service
(866) 376-4316 Fax

www.canadianacabinets.com

DEFINITIONS

1. *Canadiana Cabinets*, hereafter referred to as “The Manufacturer”, is a manufacturer of wood cabinetry and furniture including kitchen cabinets.
2. *Canadiana CabinetsTM* is a proprietary trade name and is used by the manufacturer and independent dealers and distributors in the promotion and sale of its related products and services.
3. “Signed Prints” are defined to be a set of drawings or plans signed by the Purchaser to acknowledge their agreement with the design and layout of the products manufactured by the manufacturer.
4. “*F.O.B. Plant*” is defined as picked up by purchaser at the manufacturer's plant.
5. “*Dealer and Distributor*” are defined as independent businesses. They are not agents of the manufacturer, or of *Canadiana Cabinets*. They market, sell, install, and service products manufactured by the manufacturer under the *Canadiana Cabinets* name.
6. “*Customer*” is defined as the person or parties who use the products manufactured by the manufacturer.
7. “*Purchaser*” is defined as the person or parties, as stated on the Purchase Order, who may be the Dealer, Distributor or Customer.
8. “*Purchase Order*” is defined as the prescribed order form for “Canadiana” products included with the Sales Catalogue.
9. “*Warranty*” is defined as the product guarantee as defined in this Sales Catalogue provided by *Canadiana Cabinets*, and specifically excludes any other representation or warranties implied, verbal or otherwise suggested by anyone.



GENERAL POLICIES

1. **CONDITIONS OF SALE** - The sale, installation, and servicing of “Canadiana” products is the sole responsibility of the Dealer and Distributor. The manufacturer will not be liable for any agreements (implied, verbal, written, or otherwise) between the customer and the Dealer or Distributor. The Dealer or Distributor will not represent itself as an agent of the manufacturer.
2. **PRODUCT & PACKAGING CHANGES** - Due to the manufacturer’s continual product research and development, the right is reserved to make reasonable changes, of any kind, without notice, and to deliver revised designs or models of goods, unless this right is specifically waived by the manufacturer in writing.
3. **PRICING POLICY - REGULAR CANADIANA PRODUCTS** - All prices shown are listed and subject to regular discounts unless otherwise indicated. Prices and specifications are subject to change without notice. All prices are F.O.B. our dock.
4. **PRICING POLICY - SPECIAL AND/OR NON-STANDARD PRODUCTS** - Special and Non-standard Products not listed or covered in the Canadiana Price List require “Non-standard product quotations” from Canadiana Cabinets, and are subject to special pricing for each individual order. The decision to accept any order rests entirely with the manufacturer.

If special or Non-standard Products cannot be briefly and simply described accurately, they must be accompanied by drawings or sketches and specifications.

The manufacturer assumes no liability and provides no warranty for Dealer or customer designed, engineered and finished items or assemblies.

The manufacturer reserves the right to not accept orders for special items which, in their opinion, are not suited to their manufacturing facilities or systems or which would not be in the best interests of the manufacturer to produce.

5. **DELIVERY** - Shipments will be made by the manufacturer to a particular area at a given time. Shipments within our distribution area, around Ontario, will be made at a distribution area percentage of the net cost of the merchandise. For shipments to areas not serviced by regular delivery, the manufacturer may use common carrier. *The dealer is responsible to provide adequate assistance with unloading and be able to verify with the driver that all items on the pink shipping documents have been received. Once the driver leaves the premises, we will not accept claims for undelivered goods that have been signed for. This does not affect our willingness to deal with goods that are in error or dealt with by a back order.*
6. **DROP SHIPMENTS** - For deliveries that are not to the Dealer or Distributor’s regular place of business, there will be an additional drop shipment charge of \$125.00 net for each location, whether shipped by the manufacturer or common carrier.



GENERAL POLICIES

7. **SHIPPING DAMAGE-** Merchandise must be inspected by the Dealer at the time of delivery, and:
If delivered by the manufacturer: Damaged items should be reloaded onto the van and returned to the factory.
If delivered by Common Carrier: Damaged items should be either refused or a damage claim, against the carrier, should be processed immediately. *Note: Damages resulting from common carrier shipments must be processed between the Dealer or Distributor and the Common Carrier, not through the manufacturer.*
8. **RETURN FOR CREDIT - Must be Authorised - Must be Prepaid.** No cabinets, counters, or materials may be returned for credit without the prior authorization of the manufacturer. RGA form must be submitted.
All custom or installed cabinets approved for credit will be credited at 50% of net price originally invoiced .
9. **AUTHORIZED RETURNS FOR REWORK OR REPLACEMENT** - Drivers will not pick up items for return without prior written authorization from the manufacturer. Please obtain a return authorization number from the order desk. *All returns must be well packaged.*
10. **COLOUR MATCHING** - the manufacturer will colour match as closely as possible. Colour matches for new or replacement orders should be identified explicitly. Dealers and Distributors must send the factory a sample adjacent to the area receiving the new colour matched item(s), if requested. Colour matching of discontinued Canadiana™ styles or finishes, if available, will have an extra factory finishing set-up charge of the total list price of the units to be matched in the same colour, with a \$50.00 minimum charge to apply.
11. **RUSH HANDLING CHARGES-** All orders requiring rush shipping and having a net invoice cost of \$400.00 or less before HST will have a rush handling charge of \$30.00 net added to the invoice if shipped by bus, or \$18.00 net if shipped by any other means (please specify) not including freight. These orders will be shipped freight collect unless other instructions are given. You can avoid rush handling charges by specifying that shipment should be made with your next regular delivery. Most of these small orders are for mouldings, hardware, etc. and we urge all Dealers to carry and build some inventory of these common items.
12. **CHANGES AND CANCELLATION OF ORDERS** - The elapsed time between receipt of an order and its entry into manufacturing is very short, therefore, order changes and cancellations can be very costly to the Dealer and to the customer. We make every effort to enter your order accurately, however mistakes can happen. **Please check your order and confirmation carefully.** Your original order should be accurate and changes should be avoided if at all possible. Once a confirmation is signed changes will be up to the discretion of the Production Manager, and a \$75.00 minimum net change-order charge will apply in addition to any costs for materials already ordered. Charges for cancellation of a confirmed order will be determined by the Production Manager.



GENERAL POLICIES

13. **TERMS OF PAYMENT** - All orders are C.O.D., unless credit has been established by our Credit Department, at which time our terms are to be determined on an individual basis.
14. **TAXES** - HST is not included in any catalogue price.
15. **DISPLAY DISCOUNT** - Display orders must fall within the “Standard Lead Time” for the appropriate product line to qualify for discount.
16. **PRODUCT WARRANTY** - The manufacturer warrants to the original purchaser that the manufacture of its products is to be free from defects in materials and workmanship under normal household use and service

**FOR A PERIOD OF FIVE YEARS...
...FOLLOWING THE DATE OF PURCHASE.**

Any product or part covered by this 5 year limited warranty which, *in the reasonable judgement of the manufacturer, proves to be defective, will be either replaced or repaired by THE MANUFACTURER through the Dealer or Distributor from whom the products were originally purchased. The manufacturer shall have the final decision as to whether repair or replacement is the proper remedy.*

WARRANTY CONDITIONS - Purchasers wishing to make a claim under this warranty must notify the original Dealer or Distributor from whom they purchased the product. Proof of purchase shall be required before the claim is acknowledged. *The obligation of THE MANUFACTURER, under this warranty, is only limited to the repair or replacement of the defective product or part. In the event that replacement is necessary, and an exact replacement is not available, one of similar type and equal quality will be supplied.*

WARRANTY EXCLUSIONS - This warranty does not cover damages which result from: neglect, accidental or intentional damage, normal wear and tear, repairs or alterations not authorised by the manufacturer, exposure to extremes in temperature and/or humidity, flood, fire, Acts of God, or any other cause beyond human control, use for purposes other than that for which the product was manufactured, damages or injury caused during installation or by shipping and handling.

This warranty does not cover the fracture of painted finish due to movement and shrinkage of wood products.



(705) 243-7871 Customer Service
(866) 376-4316 Fax

www.canadianacabinets.com

Policies A 5

GENERAL POLICIES

WARRANTY EXCLUSIONS cont.”-

This warranty does not cover nor apply to any item, product, part, or material not sold or manufactured by the manufacturer. Notwithstanding, the same may have been sold by the Dealer or Distributor.

For all products sold to a Dealer or Distributor, this warranty excludes labour, installation, servicing costs, overhead costs, and all other costs other than the cost to replace or repair the defective products manufactured by the manufacturer, delivered to the Dealer or Distributor.

LIMITS OF LIABILITY - the manufacturer's liability, under any of the aforesaid warranty, is limited to the cost to the manufacturer to rectify the defective work or material to a maximum aggregate limit of the wholesale purchase price to the dealer. The maximum aggregate limit will be reduced by the amount of any payments or costs previously made or incurred by the manufacturer under, or in respect of, the warranty. Save for the above liability, the manufacturer shall not be liable for any other costs, expenses, or damages of any kind whatsoever, whether direct, indirect, or consequential, and no matter howsoever caused, and the Purchaser, for good and valuable consideration, hereby remises, releases, and forever discharges the manufacturer of any and all other claims and demands of whatever nature.

NON-WAIVER - No action or failure to act by the manufacturer shall constitute a waiver of any present or future right, limitation, or defence afforded to the manufacturer under the Warranty provisions herein. Nor shall any such action or failure to act constitute an approval of, or acquiescence to, any present or future warranty claim.

ACCEPTANCE - The acceptance of the manufactured products or the submission of a claim hereunder by the Purchaser shall constitute the Purchaser's acceptance and agreement to be bound by the provisions of this Warranty.

WARRANTY TRANSFERABILITY - This warranty is with the original Purchaser and not transferable to any subsequent owner.



GENERAL POLICIES

ORDER ENTRY POLICY - It has been our practice to use our confirmation copy for production. This means that both our order desk staff and the plant staff have had to interpret the plan. This was cumbersome and led to some confusion and error. We will now submit your original order as it is placed, with all detail provided, as the only information on the shop floor. The confirmation will be for pricing and delivery date only.

In order to serve you better, we ask for orders to be placed in the following format:

1. **All orders** to be emailed to orders@canadianacabinets.com. No telephone orders can be accepted. *Please do not call the factory direct.* While this may seem an easy fix for some minor problem, the logistical nightmare that ensues is very disruptive and costly.
2. A scale drawing showing windows, doors, appliance openings and clearly visible Canadiana codes is required. Computer generated plans are preferred. Elevations are helpful but not necessary. Orders not readable will be returned and this will cause unnecessary delays.
3. A completed and signed Canadiana order form, with all pertinent information.
4. Detailed drawings of all custom cabinets or modifications. We cannot enter an order for custom cabinets without a clearly marked full page detail. (Have quoted prior)
5. Completed panel order and filler forms if required. Remember to mark grain direction, finished ends, and edge tape requirements.
6. Any quotations issued to you for particular items must be included in your order.

Orders can be submitted 24 hours a day, via e-mail. Your order will be entered for pricing and emailed back to you for review. This is your only opportunity to check the accuracy and interpretation of your order. Please note that the signed confirmation starts the clock. It is important that you confirm your order promptly.

All signed confirmations will be processed and put into production within 48 hours. At this time a delivery date will be set based upon our posted lead times, plus any additional time required due to special finishes, etc. Shipping dates are based on confirmation date. If your confirmation is returned with many changes being required, we will require a final confirmation to confirm we have understood your requests.



GENERAL POLICIES

ORDER ENTRY - All orders, once confirmed, will be scheduled as production space is available . Add lead time for specials as required.

Delivery of in-stock items, ordered on a rush service order form, will be scheduled following 3-4 production days, and rush service orders requiring doors or non-stock items will be scheduled for the week following 15 production days. It is important that you specify on the order how you would like your RSOs to be shipped.

Please note on your order form if you have an order that is required sooner than the standard lead time. We will check production and let you know when the earliest shipping time might be available for you. Please note that changes to the production calendar are completely at the discretion of the plant manager.

SERVICE ORDERS - Delivery of non finished in-stock items (hinges slides etc.), ordered on a rush service order form, will be shipped within 3-4 production days from signed confirmation. Rush service orders requiring finished parts produced in house will be scheduled for the week following 10 production days from signed confirmation. Rush service orders requiring finished parts that are outsourced will be scheduled for shipment the week following 15 production days from signed confirmation.

*Because of the time frame, and urgency of service orders, once a service order (***.44) is confirmed, it cannot be changed.*

Service orders under \$400 before discount are subject to the following charges:

Finish set up for standard stained colours	\$25.00 net
Finish set up for standard painted colours	\$50.00 net
Finish set up for structured multi step finish	\$75.00 net

It is important that you specify on the order how you would like your RSOs to be shipped.



CABINET CODES

BASE CABINETS

FHB	full height base with door & no top drawer
FHSB	full height sink base with door & interior sink skirt
FHBBC	full height base blind corner with door & no top drawer
B	base cabinet with door & 1 top drawer
B/S	base cabinet with door & 2 top drawers
SB	sink base cabinet with door & 1 top false drawer front
SB/S	sink base cabinet with door & 2 top false drawer fronts
DB	drawer bank with single row of drawers
DB/S	drawer bank with single row of drawers & 2 top drawers
FHBC	full height pie-cut base corner cabinet with bi-fold door & no top drawer (left size first)
BC	base pie-cut corner cabinet with bi-fold door & false drawer fronts (left size first)
BBC	base blind corner cabinet with door & 1 top drawer c/w 25 ½" panel
FHDBC	full height diagonal base corner cabinet with single door & no top drawer
DBC	diagonal base corner cabinet with single door & false drawer front
FHBCH	full height base corner hutch cabinet with doors and profiled fillers

UPPER CABINETS

U	upper cabinet standard depth with door
UD	upper cabinet 24" deep with door
UDC	upper diagonal corner cabinet with door
UCC	upper bi-fold door pie-cut corner cabinet, (left size first)
UBC	upper blind corner cabinet with door c/w 13 ½" panel
UDD	upper door drawer cabinet with door & drawer below
UDA	upper dual access cabinet with doors on both faces
MOC	microwave oven cabinet with door above box

UPPER CABINETS cont'd

UH	upper hutch cabinet 4" gables with 2 doors
UAE	upper angled end cabinet with 1 door
MOB	microwave oven box cabinet

TALL CABINETS

T	tall pantry cabinet with door
TO	tall oven cabinet with open center section, doors above & below
TO1D	tall oven cabinet with open center section, doors above & 1 drawer & door below
TO3D	tall oven cabinet with open center section, 3 drawers below
TMOV	tall oven cabinet with double open center section with doors above & drawer below
SW	storage wall cabinet with door
THC	tall hutch cabinet 4" gables with 2 doors
TAE	tall angled end cabinet with 1 door

VANITY CABINETS

VFHB	vanity full height base with door & no top drawer
VFHSB	vanity full height sink base with door & interior sink skirt
VB	vanity base cabinet with door & 1 top drawer
VS	vanity sink base cabinet with door & 1 top false drawer front
VB/S	vanity base cabinet with door & 2 top false drawer fronts
VDB	vanity drawer bank with row of drawers
VFHBC	vanity full height pie-cut base corner cabinet with bi-fold door & no top drawer (left size first)
VFHDBC	vanity full height diagonal base corner cabinet with single door & no top drawer
VTL	vanity tall linen cabinet with door with vanity height kick
VBE	vanity empire height base cabinet with door & 1 top drawer (available in other vanity front options)



CUSTOM CHARGES

SIZE CHANGES

CDI - Cabinet depth increase over standard options.

CDR - Cabinet depth reduction other than standard options. (5 ½" minimum depth required for cabinets with hinges)

CHR - Cabinet height reduction. *Use next size.*

CWR - Cabinet width reduction.

CWR.75 - ¾" cabinet width reduction (To allow for Overlay Panels).

CWR1.5 - 1 ½" cabinet width reduction.

CWI - Cabinet width increase when size required goes beyond available sizes. *Add 25% of base price or combine 2 cabinets +15% (must factor).*

CHIU (UPPER) Cabinet height increase for cabinets up to 48" high *use next higher cabinet size, +15% of base price. (must factor).*

Cabinets larger than 48" high, combine 2 cabinets +15% (must factor).

CHIB (BASE) Cabinet height increase. *add 25% of base price (must factor).*

CONSTRUCTION CHANGES

CDA - Custom dual-access. *Add 75% of base price. (must factor).*

CAO - Cutout around obstruction.

EBG - Extend base gable depth beyond back of cabinet, max 6".

EUG - Extend upper gable depth beyond back of cabinet, max 6".

ETG - Extend tall gable depth beyond back of cabinet, max 6".

CUC - Clip upper cabinet corner 3" or 6" 45 degrees ONLY*

CBC - Clip base cabinet corner 3" or 6" 45 degrees ONLY*

CTC - Clip tall cabinet corner 3" or 6" 45 degrees ONLY*

CAC - Custom angle on cabinet

CCAB - Custom cabinet charges for miscellaneous customization*

MUB - Make upper unit as base spec without kick (30 ¼" h with door reveal at top)

AFS - Alter front sizes on a standard cabinet other than those offered

RTK - Remove toe kick at bottom of both gables.

RTKLEG - Remove toe kick at bottom of gable and install adjustable cabinet legs.

ATK - Alter toe kick height involving changes to the cabinet face.

OPEN CASE - For cabinets supplied without doors. **(1.25 factor)**

RGD - Replace gable with integral door.

CASSEM - Custom assembly charges for panels & columns



*Please supply a detailed drawing of cabinet to be altered

CUSTOM CHARGES

CONSTRUCTION CHANGES Cont'd

BA1- Build two units a one cabinet (combine price+)

DR6COMPLETE- Add an Integra drawer to a standard cabinet

DR12COMPLETE - Add an Integra drawer to a standard cabinet

SHOP - General shop time

DUCB - Delete upper cabinet bottom

SP-IREG - Irregular shape cut to panels

FDS - Full depth shelf upgrade.

MAP - Moulding applied to panel

GTF - Base gable made without kick notch

GTFL - Base gable made without kick notch on *Left Gable Only***

GTFR - Base gable made without kick notch on *Right Gable Only***

INTERIOR FINISHING OPTIONS

FININT - MM - Finished interior Maple Melamine

FININT - CAN - Finished interior K21 Canvas

FININT-DM - Finished interior Designer melamine

FININT-MAPLE, OAK, PINE - Finished interior in Specified Species

FININT-CHERRY, WMAPLE, ALDER, PAINT - Finished interior in Specified Species



**Please supply a detailed drawing of cabinet to be altered
**Please note that finished interior is required if kick not installed flush to front.*

(705) 243-7871 Customer Service
(866) 376-4316 Fax

www.canadianacabinets.com

Policies A 11

CANADIANA CABINET TYPES

CABINET CONSTRUCTION TYPE	DETAILS	ADD TO DOOR FACTOR	OPEN CASE FACTOR	STANDARD DRAWER TYPE
Canadiana	Standard Cabinet Line	N/A	1.25	White Integra c/w matching parts
Excellence - Plywood	Plywood Construction	1.35	2.35	Double Wall/full extension soft closing
Country Classic Frame - Maple Melamine	Traditional Face Frame Construction	1.15	2.10	Double Wall/full extension soft closing
Country Classic Frame - Maple Plywood	Traditional Face Frame Construction	1.50	2.50	Dovetail Drawers c/w Full Extension Slides
Avonlea Frame - White or Maple Melamine	Face Frame with Inset Door	1.25	2.20	Double Wall /full extension soft closing
Avonlea Frame - Maple Plywood	Face Frame with Inset Door	1.60	2.60	Dovetail Drawers c/w Full Extension Slides

Complete Cabinet Example

<u>Cabinet Name & Cabinet Line</u>	<u>Base Price</u>	x	<u>Door Style Factor</u>	=	<u>List price (Retail price)</u>
U3030 (including door) Avonlea Frame Maple Plywood	\$156.00	x	(2.00 + 1.60) = 3.60	=	\$561.60
U3030 (including door) Country Classic Frame Maple Plywood	\$156.00	x	(2.00 + 1.50) = 3.50	=	\$546.00

Open Case Example

<u>Cabinet Name & Cabinet Line</u>	<u>Base Price</u>	x	<u>Door Style Factor</u>	=	<u>List price (Retail price)</u>
U3030 OPEN CASE Avonlea Frame Maple Plywood	\$156.00	x	2.60	=	\$405.60
U3030 OPEN CASE Country Classic Frame Maple Plywood	\$156.00	x	2.50	=	\$390.00

© 2015 - 2020 Canadiana Cabinets Ltd | Revised April 2020



(705) 243-7871 Customer Service
(866) 376-4316 Fax

www.canadianacabinets.com

Policies A 12

CANADIANA CABINET TYPES

“CANADIANA” (Frameless, 5/8" Melamine)

- Frameless European case construction.
- Door & drawer fronts flush to edge of case with 1/16" clearance.
- 5/8" Melamine Case Construction with Integrated Finished Ends.
- 5/8" thick melamine back, captured into dados on four sides and secured with glue.
- Cabinet assembled with CNC aligned dowels and glue construction.
- Undersides of upper cabinets match the inside of the case. *Can be finished to match exposed surfaces as option.*
- Gables Notched for Toe Kick (4 1/4" H on Kitchen cabinets, 6 1/4" on Vanity cabinets).
- 5/8" Melamine adjustable shelves on 5mm steel shelf clips.
- Grass Tiomos , 6-way adjustable, inline hinge with cover cap.
- Grass Integra white epoxy steel drawer system.
- Hand applied finishes.
- Available in all standard Canadiana door & drawer styles in all wood species.

All of our cabinets are custom built to order, lead time for standard finishes is 4 to 6 weeks.

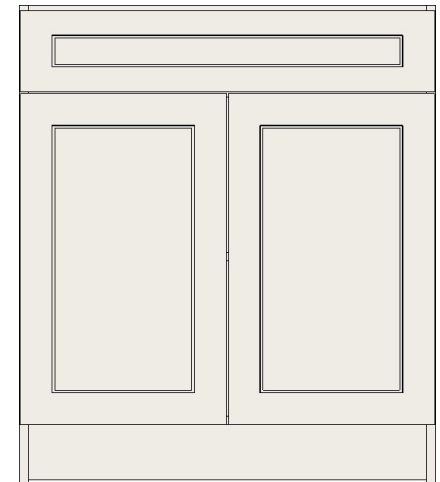
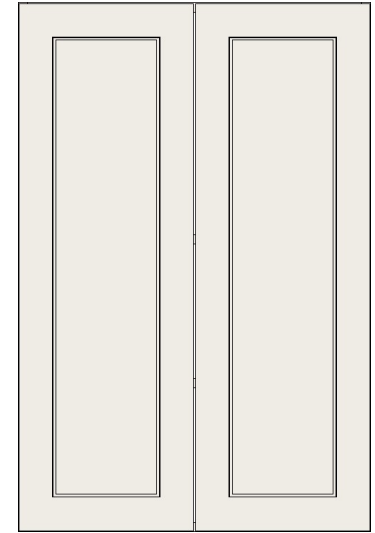

CANADIANA CABINET TYPES

“EXCELLENCE” (Frameless, 5/8" Maple Plywood)

- Frameless European case construction.
- Full-Overlay doors and drawer fronts with 1/8" reveal between adjacent doors
- 5/8" Maple Plywood case construction with integrated finished ends.
- 5/8" thick maple plywood back, captured into dados on four sides and secured with glue.
- Cabinet assembled with CNC aligned dowels and glue construction.
- Undersides of upper cabinets match the inside of the case. *Can be finished to match exposed surfaces as option.*
- All cabinet face edge tape matches job colour, using PVC or stained / painted veneer tape.
- Adjustable cabinet legs (4 1/4"H on kitchen cabinets, 6 1/4"H on vanity cabinets).
- 3/4" Maple Plywood notched adjustable shelves on 5mm metal shelf clips.

- Grass Tiomos, Soft Close, 6-way adjustable, inline hinge with cover cap.
- Grass DWD-XP Double wall drawer system c/w “Soft Close” matching melamine parts.

- Hand applied finishes.
- Available in Maple and Paint with integrated finished ends, All other species require Overlay Panels

All of our cabinets are custom built to order, lead time for standard finishes is 4 to 6 weeks.

*All cabinet components in the Country Classic Line are build using plywood.
Fillers, Show Panels, Toe Kick, etc., will be made from standard material.*

*If you would like plywood used for every item in the project, please specify on your order.
Plywood Pricing available upon request.*

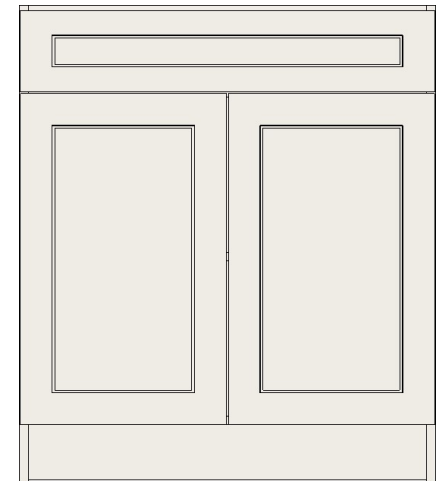
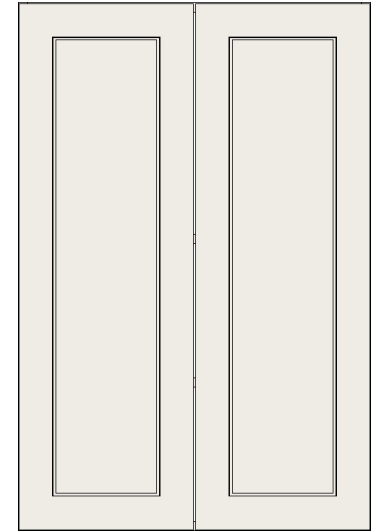

CANADIANA CABINET TYPES

“COUNTRY CLASSIC” (Traditional Face Frame Construction, Maple Plywood)

- Full front face frame 1 ¼" wide x 13/16" thick c/w micro edge bevel as required.
- ½" overlay of frame by doors & drawer fronts, ¾" exposed frame.
- Solid Wood Face frame are glued to cabinet case. (No pin holes in the face of cabinets).
- 5/8" Maple Plywood Case Construction with Integrated Finished Ends.
- 5/8" thick maple plywood back, captured into dados on four sides and secured with glue.
- Cabinet assembled with CNC aligned dowels and glue construction.
- Undersides of upper cabinets match the inside of the case. Can be finished to match exposed surfaces as option.
- Adjustable cabinet legs (4 ¼"H on kitchen cabinets, 6 ¼"H on vanity cabinets).
- ¾" Maple Plywood notched adjustable shelves on 5mm metal shelf clips.
- Grass Tiomos, Soft Close, 6-way adjustable, inline hinge with cover cap.
- 5/8" solid hardwood dovetail drawer boxes.
- Grass DynaPro Full Extension Undermount Slides (with 6 way adjustment).
- Hand applied finishes.
- Available in all standard Canadiana door & drawer styles in all wood species. (No MDF Frames)

“COUNTRY CLASSIC” (Traditional Face Frame Construction, Maple Melamine Construction)

Same as above except for the following:

- 5/8" Maple Melamine Case Construction with Integrated Finished Ends (*instead of plywood*).
- 5/8" Maple Melamine adjustable shelves on 5mm steel shelf clips (*instead of notched ¾" plywood*).
- Grass DWD-XP Double wall drawer system c/w “Soft Close” matching melamine parts. (*instead of Dovetail Drawer box*).

All of our cabinets are custom built to order, lead time for standard finishes is 5 to 6 weeks.

All cabinet components in the Country Classic Line are build using plywood. Fillers, Show Panels, Toe Kick, etc., will be made from standard material.

If you would like plywood used for every item in the project, please specify on your order. Plywood Pricing available upon request.

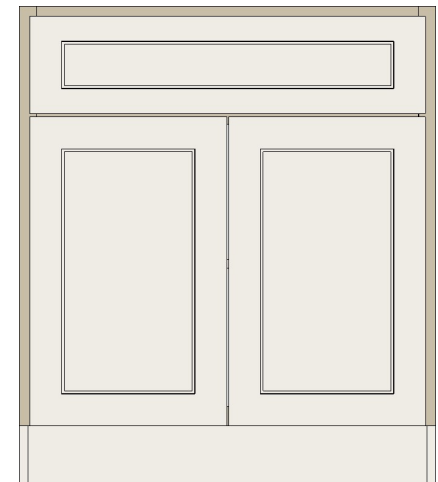
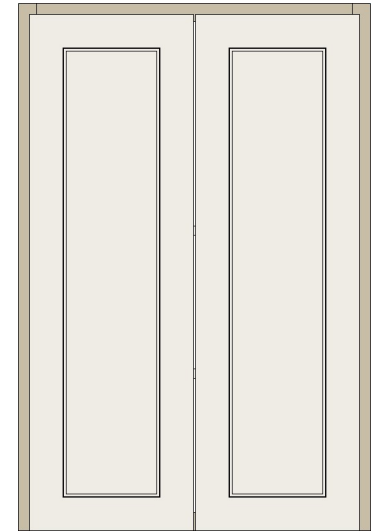

(705) 243-7871 Customer Service
(866) 376-4316 Fax

www.canadianacabinets.com

Policies A 15

CANADIANA CABINET TYPES

“AVONLEA” (Applied bead on frame c/w Inset Door, Maple Plywood)

- Full front face frame 1 ½" wide including bead x 13/16" thick c/w micro edge bevel as required.
- Door & drawer fronts are inset flush into front of face frame.
- Solid Wood Face frame are glued to cabinet case (No pin holes in the face of cabinets).
- 5/8" maple plywood case construction, overlay panels used for finished ends.
- 5/8" thick maple plywood back, captured into dados on four sides and secured with glue.
- Cabinet assembled with CNC aligned dowels and glue construction.
- Undersides of upper cabinets match the inside of the case. Can be finished to match exposed surfaces as option.
- Adjustable cabinet legs (4 ¼"H on kitchen cabinets, 6 ¼"H on vanity cabinets).
- ¾" Maple Plywood notched adjustable shelves on 5mm metal shelf clips.
- Grass Tiomos, Soft Close, 6-way adjustable, inline hinge with cover cap.
- 5/8" solid hardwood dovetail drawer boxes.
- Grass DynaPro Full Extension Undermount Slides (with 6 way adjustment).
- Hand applied finishes
- Available in all standard Canadiana door & drawer styles in all wood species (No MDF Frames).

“AVONLEA” (Applied bead on frame c/w inset door, Maple Melamine Construction)

Same as above except for the following:

- 5/8" Maple Melamine Case Construction (*instead of plywood*).
- 5/8" Maple Melamine adjustable shelves on 5mm steel shelf clips (*instead of notched ¾" plywood*).
- Grass DWD-XP Double wall drawer system c/w “Soft Close” matching melamine parts (*instead of Dovetail Drawer box*).

All of our cabinets are custom built to order, lead time for standard finishes is 5 to 6 weeks.

*All cabinet components in the Avonlea Line are build using plywood.
Fillers, Show Panels, Toe Kick, etc., will be made from standard material.*

*If you would like plywood used for every item in the project, please specify on your order.
Plywood Pricing available upon request.*

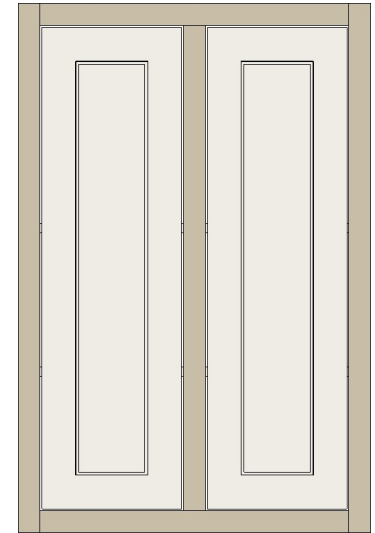

Avonlea Inset Doors are ¼" smaller than the opening



(705) 243-7871 Customer Service
(866) 376-4316 Fax

www.canadianacabinets.com

Policies A 16

WARRANTY

Canadiana™ kitchen and bath cabinetry is warranted to be free of defects as outlined in the following statement:

1. This document represents the complete and only warranty; any other warranties previously expressed or implied or stated are replaced by this warranty. This warranty is subject to provincial, federal, and state laws.
2. The manufacturer warrants its products for a period of (5) five years following the delivery date only to the original purchaser against manufacturing defects providing the products have been used under normal household conditions.
3. This warranty shall become null and void if the products have been subject to abuse, negligence or faulty installation.
4. Wood is a product of nature. Variations in grain, texture and/or colour reconsidered to be part of the inherent beauty of the wood and do not constitute a defect. Similarly, wood is affected by adverse or excessive exposure to high humidity levels and/or temperature changes. No claim will be considered that is deemed to be a result of such exposure.
5. External deterioration of surface finish due to normal wear does not constitute a defect under the terms of this warranty.
6. If a product has been modified by persons other than factory personnel and that modification contributes product faultiness, no claim will be considered.
7. Products used in commercial or institutional settings are not eligible under this warranty.
8. The manufacturer's liability is limited to the repair or replacement of the product or components which have been found to be defective. The manufacturer will assume the cost of the parts or components along with the transportation of these parts to the customer's home. **Note:** *The manufacturer will not be liable for any labour or installation costs incurred.*

Hardware warranty:

9. If a hinge ever fails during the normal course of use it will be replaced without charge to the customer even if that customer is not the original purchaser.
10. If a drawer slide ever fails during the normal course of use, it will be replaced, without charge, to the customer even if that customer is not the original purchaser. This life time warranty pertains to the life of the kitchen where it was originally installed. **Note:** *The manufacturer will not be liable for any labour or installation costs incurred.*
11. Doors over 42" in size without a support divider rail are not warranted for warping.
12. For general care and maintenance of all finishes, clean only with approved materials and use only soft cloths to avoid scratching. To obtain the longest product life, avoid the use of soaps, cleaners, solvents, waxes, ammonia and other household chemicals known to be detrimental to finishes. Refrain from using paper products to clean wood finishes.

Dealer Name

Date of purchase

Door style

Colour

Customer name

Manufacture's invoice reference

Dealer signature

Mailing Address

311 Plati Ave.
Peterborough, ON
K9L 1C8

Customer Service (705) 243-7871
Fax (866) 376-4316

inquiries@canadianacabinets.com



COMMERCIAL WARRANTY

Canadiana™ kitchen and bath cabinetry is warranted to be free of defects as outlined in the following statement:

1. This document represents the complete and only warranty; any other warranties previously expressed or implied or stated are replaced by this warranty. This warranty is subject to provincial, federal, and state laws.
2. The manufacturer warrants its products for a period of (1) one year following the delivery date only to the original purchaser against manufacturing defects providing the products have been used under normal household conditions.
3. This warranty shall become null and void if the products have been subject to abuse, negligence or faulty installation.
4. Wood is a product of nature. Variations in grain, texture and/or colour reconsidered to be part of the inherent beauty of the wood and do not constitute a defect. Similarly, wood is affected by adverse or excessive exposure to high humidity levels and/or temperature changes. No claim will be considered that is deemed to be a result of such exposure.
5. External deterioration of surface finish due to normal wear does not constitute a defect under the terms of this warranty.
6. If a product has been modified by persons other than factory personnel and that modification contributes product faultiness, no claim will be considered.

7. The manufacturer's liability is limited to the repair or replacement of the product or components which have been found to be defective. The manufacturer will assume the cost of the parts or components along with the transportation of these parts to the customer's home. **Note:** *The manufacturer will not be liable for any labour or installation costs incurred.*

Hardware warranty:

8. If a hinge ever fails during the normal course of use it will be replaced without charge to the customer even if that customer is not the original purchaser.
9. If a drawer slide ever fails during the normal course of use, it will be replaced, without charge, to the customer even if that customer is not the original purchaser. This life time warranty pertains to the life of the kitchen where it was originally installed. **Note:** *The manufacturer will not be liable for any labour or installation costs incurred.*
10. Doors over 42" in size without a support divider rail are not warranted for warping.
11. For general care and maintenance of all finishes, clean only with approved materials and use only soft cloths to avoid scratching. To obtain the longest product life, avoid the use of soaps, cleaners, solvents, waxes, ammonia and other household chemicals known to be detrimental to finishes. Refrain from using paper products to clean wood finishes.

Dealer Name

Date of purchase

Door style

Colour

Customer name

Manufacture's invoice reference

Dealer signature

Mailing Address

311 Plati Ave.
Peterborough, ON
K9L 1C8

Customer Service (705) 243-7871
Fax (866) 376-4316

inquiries@canadianacabinets.com



