

Index to section “J” Components & Decorative

Index J 1

Cabinet Hardware

Hinges J 2

Drawer Upgrade Chart J 3

Drawers

Integra Drawers..... J 4

DWD-XP Drawers J 5

Melamine Drawers..... J 6

Plywood Drawers J 7

Dovetail Drawers J 8

Rollouts

Rollout Location Guide..... J 9

Integra Rollouts J 10

DWD-XP Rollouts J 11

Melamine Rollouts..... J 12

Plywood Rollouts..... J 13

Dovetail Rollouts J 14

Stained Veneer Rollouts J 15

Rollout Shelf J 16

Melamine Shelves J 17

Glass Shelves J 17

Tray Dividers J 18

Drawer Cutouts J 18

Decorative Storage

Plate Rack J 19

Bottle Storage Shelf J 19

Stemware Holders..... J 19

Lattice Wine Rack..... J 20

Bottle Storage..... J 21

Corner Appliance Garage..... J 22

Wall Appliance Garage..... J 22

Sink Tray (Tip Out)..... J 22

LED Lighting J 23

LED Covers..... J 24

LED Drivers & Leads J 25

Installation Supplies..... J 26

Range Hoods

Canadiana Range Hood..... J 27

Shaker Range Hood J 28

Hood Fan Inserts J 29

© 2015 - 2020 Canadiana Cabinets Ltd | Revised August 2021



(705) 808-1038 Customer Service
 (866) 376-4316 Fax

www.canadianacabinets.com

HINGES

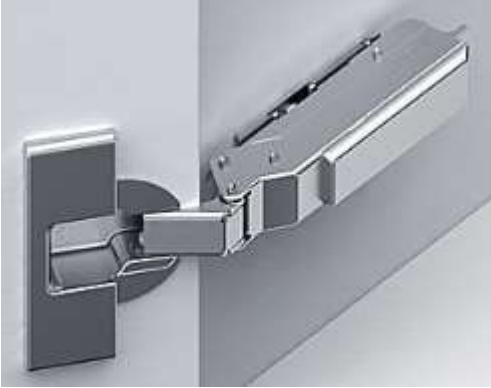
HINGES (Concealed)			
		CODE	PRICE
	Soft Close Hinges		
	Std clip-on Soft Close 110° hinge c/w plate	HINGE-110T	
	Std clip-on Soft Close 160° hinge c/w plate (susan door cabinet side c/w plate)	HINGE-160T	
	Std clip-on Soft Close 45° hinge c/w plate	HINGE-45	
	Std bi-fold hinge – 180 degree for susan door (bi-fold side c/w plate)	HINGE-BIFOLD	
	Std clip-on Soft Close 90° hinge c/w plate (blind corner)	HINGE-BLIND	
	Drill for hinges (no hinges supplied) per door	HINGE-DRILLING	
	Country Classic Standard hinges (concealed)	HINGE-CLASSIC	
	Avonlea Standard hinges - available in Satin Nickel, Antique Brass, Bright Brass	HINGE-AVONLEA	
	Tiomos Hinge Angle Reduction Clip (85° door opening)	TARC	

© 2015 - 2020 Canadiana Cabinets Ltd | Revised August 2021



(705) 808-1038 Customer Service
 (866) 376-4316 Fax

www.canadianacabinets.com

Components & Decorative J 2

DRAWER UPGRADE CHART

	CABINET LINE **with Standard Drawer**		
Drawer Type	CANADIANA **Integra**	EXCELLENCE AVONLEA (Maple Melamine) COUNTRY CLASSIC (Maple Melamine) **DWD-XP**	AVONLEA (Maple Plywood) COUNTRY CLASSIC (Maple Plywood) **Dovetail**
Integra Steel Wall Drawer System	STANDARD	N/C Option	N/C Option
DWD-XP Full extension soft close double wall drawer 6" DWD-XP 12" DWD-XP		STANDARD STANDARD	N/C Option
Melamine Box w/full extension soft close guides 4 ¼" Melamine Box 8" Melamine Box	<i>Priced by width</i>	<i>Priced by width</i>	N/C Option
Maple Plywood Box w/full extension soft close guides 4 ¼" Maple Plywood Box 8" Maple Plywood Box	<i>Priced by width</i>	<i>Priced by width</i>	N/C Option
Dovetail Drawer Box w/Full Extension Soft Close Guides 4 ¼" Maple Dovetail Box 8" Maple Dovetail Box	<i>Priced by width</i>	<i>Priced by width</i>	STANDARD

© 2015 - 2020 Canadiana Cabinets Ltd | Revised August 2021



(705) 808-1038 Customer Service
(866) 376-4316 Fax

www.canadianacabinets.com

Components & Decorative J 3

DRAWERS

DWD-XP DRAWER BOX (DOUBLE-WALL DRAWER FULL EXTENSION)

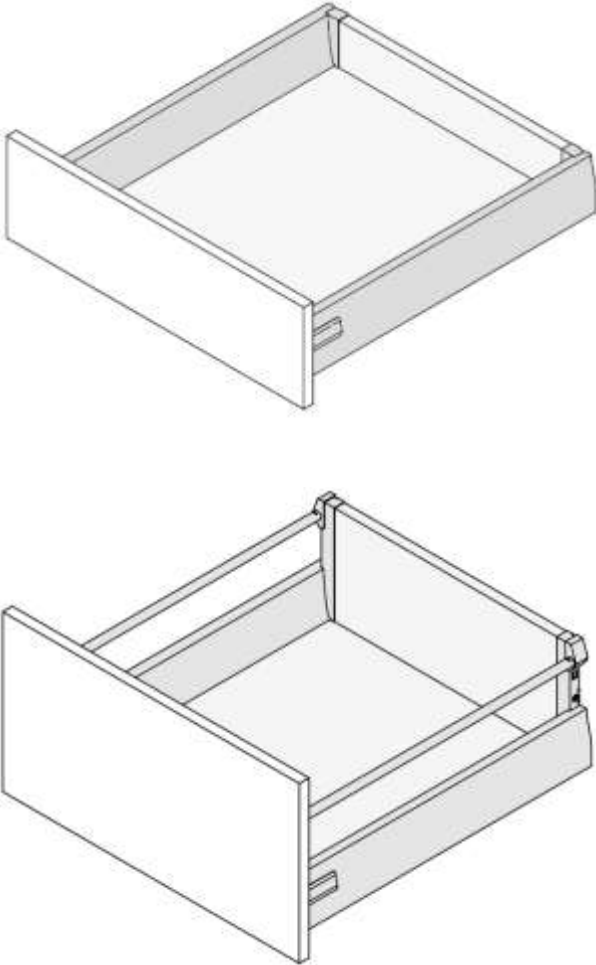
	SPECIAL CONSIDERATIONS: To replace standard Integra drawer in frameless cabinets. Min. 4" high	CODE	PRICE
	<p>4" Grey Full Extension Soft Close Drawer System (each) 8" Grey Full Extension Soft Close Drawer System with Gallery Rails (each)</p> <p>Standard Depth is 500mm (Approx. 20"). Also Available in the following Depths: 275mm, 350mm, 400mm, 450mm <i>550mm & 650mm drawers available upon request, contact Customer Service for pricing</i></p> <p>DWD-XP Drawers use 5/8" thick <i>Uniboard 805 Sunset Grey</i> melamine for drawer bottom and back</p>	<p>DWDXP6 DWDXP12</p>	

Increase the weight capacity of a drawer from 40Kg to 60Kg, by adding code: DWD-XL. \$36.00 charge



(705) 808-1038 Customer Service
(866) 376-4316 Fax

www.canadianacabinets.com

Components & Decorative J 5

DRAWERS

MELAMINE DRAWER BOX

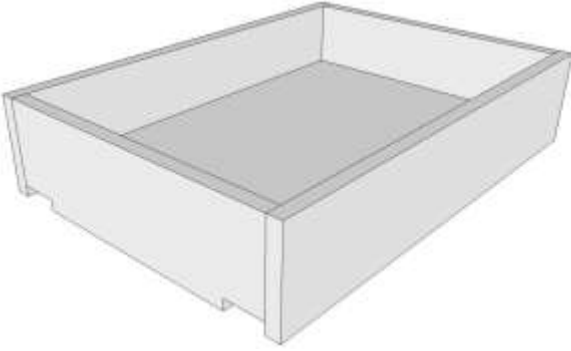
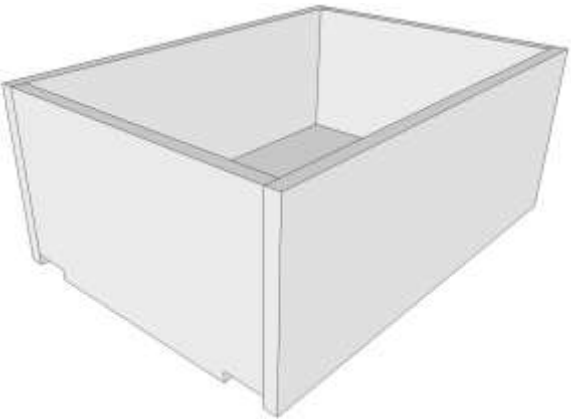
	SPECIAL CONSIDERATIONS: To replace standard Integra drawer in frameless cabinet. Specify <i>white</i> or <i>Classic Maple Wood Grain Melamine</i> (Default matches Case interior)	CODE	PRICE
	<p>4 1/4" Drawer - 5/8" Melamine 40kg full extension soft close guides for cabinet size:</p>	B09 MEL09 B12 MEL12 B15 MEL15 B18 MEL18 B21 MEL21 B24 MEL24 B27 MEL27 B30 MEL30 B33 MEL33 B36 MEL36 B39 MEL39 B42 MEL42 B45 MEL45 B48 MEL48	
	<p>8" Drawer - 5/8" Melamine 40kg full extension soft close guides for cabinet size:</p> <p>Standard Depth is 500mm (Approx. 20"). Also Available in the following Depths: 300mm, 350mm, 400mm, 450mm <i>550mm & 650mm drawers available upon request, contact Customer Service for pricing</i></p>	B09 MELD09 B12 MELD12 B15 MELD15 B18 MELD18 B21 MELD21 B24 MELD24 B27 MELD27 B30 MELD30 B33 MELD33 B36 MELD36 70kg Slides - B39 MELD39 70kg Slides - B42 MELD42 70kg Slides - B45 MELD45 70kg Slides - B48 MELD48	

© 2015 - 2020 Canadiana Cabinets Ltd | Revised August 2021



Increase the weight capacity of a Melamine drawer from 40Kg to 70Kg, by adding code: DYNAPRO-XL.
Note: All 8" high Melamine drawers in cabinets 39" and larger use 70Kg slides as standard. Do not add charge to these drawers.

(705) 808-1038 Customer Service
 (866) 376-4316 Fax

www.canadianacabinets.com

Components & Decorative J 6

DRAWERS

MAPLE PLYWOOD DRAWER BOX

	SPECIAL CONSIDERATIONS: To replace standard Integra drawer in frameless cabinet.	CODE	PRICE
	<p>4 1/4" Drawer - 5/8" Maple Plywood 40kg full extension soft close guides for cabinet size:</p>	B09 PD09 B12 PD12 B15 PD15 B18 PD18 B21 PD21 B24 PD24 B27 PD27 B30 PD30 B33 PD33 B36 PD36 B39 PD39 B42 PD42 B45 PD45 B48 PD48	
	<p>8" Drawer - 5/8" Maple Plywood 40kg full extension soft close guides for cabinet size:</p> <p>Standard Depth is 500mm (Approx. 20"). Also Available in the following Depths: 300mm, 350mm, 400mm, 450mm <i>550mm & 650mm drawers available upon request, contact Customer Service for pricing</i></p>	B09 PDD09 B12 PDD12 B15 PDD15 B18 PDD18 B21 PDD21 B24 PDD24 B27 PDD27 B30 PDD30 B33 PDD33 B36 PDD36 70kg Slides - B39 PDD39 70kg Slides - B42 PDD42 70kg Slides - B45 PDD45 70kg Slides - B48 PDD48	

© 2015 - 2020 Canadiana Cabinets Ltd | Revised August 2021



Increase the weight capacity of a Plywood drawer from 40Kg to 70Kg, by adding code: DYNAPRO-XL.
Note: All 8" high Plywood drawers in cabinets 39" and larger use 70Kg slides as standard. Do not add charge to these drawers.

(705) 808-1038 Customer Service
 (866) 376-4316 Fax

www.canadianacabinets.com

Components & Decorative J 7

DRAWERS

MAPLE DOVETAIL DRAWER BOX

	SPECIAL CONSIDERATIONS: To replace standard Integra drawer in frameless cabinet.	CODE	PRICE
	4 1/4" Drawer - 5/8" Maple Dovetail 40kg full extension soft close guides for cabinet size:	B09 B12 B15 B18 B21 B24 B27 B30 B33 B36 B39 B42 B45 B48	WD09 WD12 WD15 WD18 WD21 WD24 WD27 WD30 WD33 WD36 WD39 WD42 WD45 WD48
	8" Drawer - 5/8" Maple Dovetail 40kg full extension soft close guides for cabinet size: Standard Depth is 500mm (Approx. 20"). Also Available in the following Depths: 300mm, 350mm, 400mm, 450mm <i>550mm & 650mm drawers available upon request, contact Customer Service for pricing</i>	B09 B12 B15 B18 B21 B24 B27 B30 B33 B36 70kg Slides - B39 70kg Slides - B42 70kg Slides - B45 70kg Slides - B48	WDD09 WDD12 WDD15 WDD18 WDD21 WDD24 WDD27 WDD30 WDD33 WDD36 WDD39 WDD42 WDD45 WDD48

© 2015 - 2020 Canadiana Cabinets Ltd | Revised August 2021

Increase the weight capacity of a Melamine drawer from 40Kg to 70Kg, by adding code: DYNAPRO-XL.

Note: All 8" high Melamine drawers in cabinets 39" and larger use 70Kg slides as standard. Do not add charge to these drawers.



(705) 808-1038 Customer Service
(866) 376-4316 Fax

www.canadianacabinets.com

Components & Decorative J 8

ROLLOUTS

Factory Installed Rollouts (Default Locations)

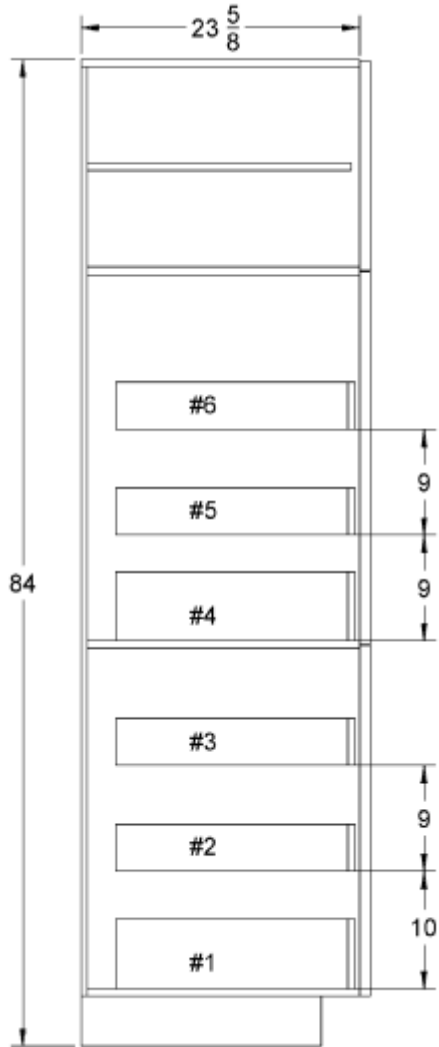

When ordering rollouts, please specify the position #

To install a rollout in a non-default location please use the code **RTI**, and attach a detailed drawing (\$26 each)

Rollout widths may be reduced to prevent interference with other hardware, as outlined below:

Rollout installed behind a single Door - Reduced by 1", to allow hinge clearance

Rollout installed behind 2 doors - Reduced by 2", to allow hinge clearance

Rollout installed behind a drawer - No reduction necessary

Bottom mount hardware will be used (on the hinge side) for Rollouts in Location #1 and #4 and the rollout width will be reduced an additional 1/2" per door.

If the rollout does not extend the width of the cabinet, add a 6" high partition (8" high for 149mm integra rollout) **RSI**(\$40 each)

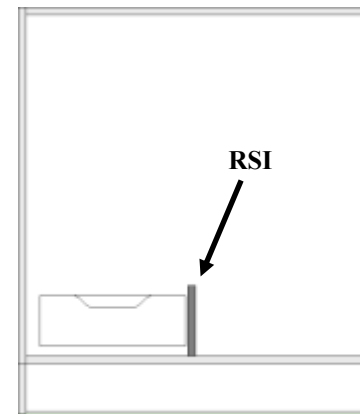
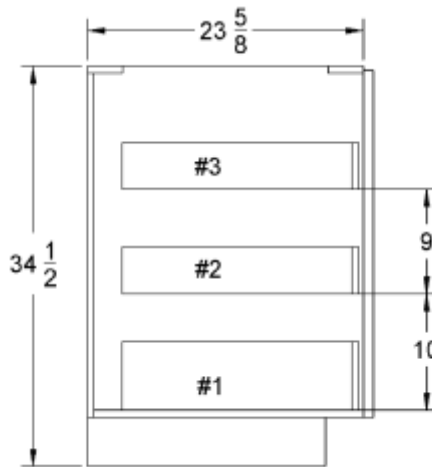

ROLLOUTS

INTEGRA (85mm & 149mm)

© 2015 - 2020 Canadiana Cabinets Ltd | Revised August 2021

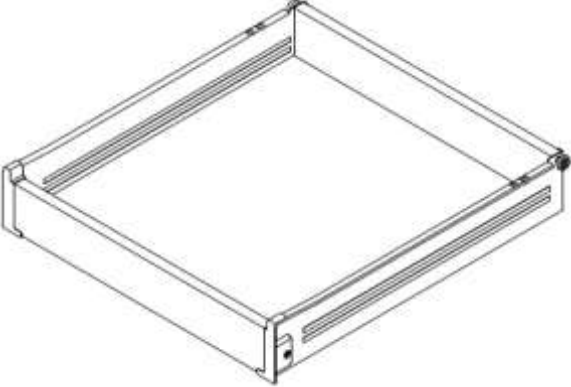
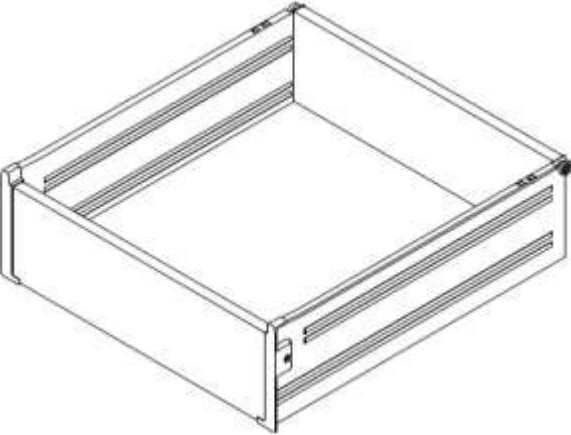
	SPECIAL CONSIDERATIONS: Factory installed, specify location-see page I3.	CODE	PRICE
	<p>Integra Rollout 85mm high, for cabinet size:</p>	B09 RT09 B12 RT12 B15 RT15 B18 RT18 B21 RT21 B24 RT24 B27 RT27 B30 RT30 B33 RT33 B36 RT36 B39 RT39 B42 RT42 B45 RT45 B48 RT48	
	<p>Integra Rollout 149mm high, for cabinet size:</p>	B09 RTD09 B12 RTD12 B15 RTD15 B18 RTD18 B21 RTD21 B24 RTD24 B27 RTD27 B30 RTD30 B33 RTD33 B36 RTD36 B39 RTD39 B42 RTD42 B45 RTD45 B48 RTD48	
<p>Add Soft Close to Integra Rollout - Up to 34 1/2" Wide Add Soft Close to Integra Rollout - Over 34 1/2" Wide</p>		SC-INTEGRA SC-INTEGRA36	



(705) 808-1038 Customer Service
 (866) 376-4316 Fax

www.canadianacabinets.com

Components & Decorative J 10

ROLLOUTS

DWD-XP ROLLOUTS

© 2015 - 2020 Canadiana Cabinets Ltd | Revised August 2021

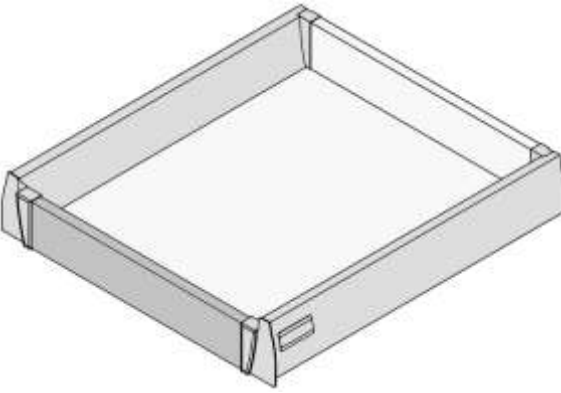
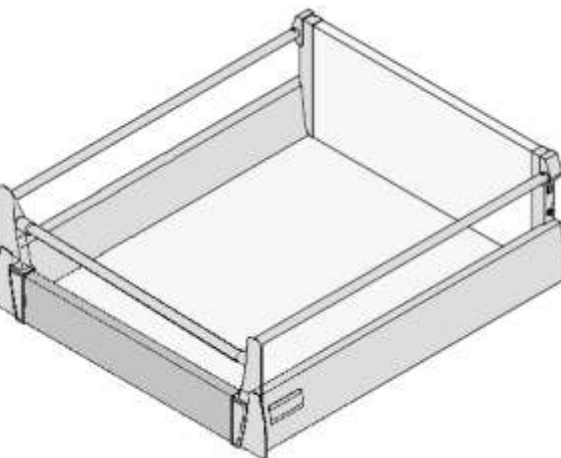
	SPECIAL CONSIDERATIONS: Factory installed, specify location-see page I3.	CODE	PRICE
	<p>4" Grey Full Extension Soft Close Rollout System for cabinet size:</p>	B09 B12 B15 B18 B21 B24 B27 B30 B33 B36 B39 B42 B45 B48	RTDWD09 RTDWD12 RTDWD15 RTDWD18 RTDWD21 RTDWD24 RTDWD27 RTDWD30 RTDWD33 RTDWD36 RTDWD39 RTDWD42 RTDWD45 RTDWD48
	<p>8" Grey Full Extension Soft Close Rollout System with Gallery Rails for cabinet size:</p> <p>DWD-XP Drawers use 5/8" thick <i>Uniboard 805 Sunset Grey</i> melamine for drawer bottom and back</p>	B09 B12 B15 B18 B21 B24 B27 B30 B33 B36 B39 B42 B45 B48	RTDWDD09 RTDWDD12 RTDWDD15 RTDWDD18 RTDWDD21 RTDWDD24 RTDWDD27 RTDWDD30 RTDWDD33 RTDWDD36 RTDWDD39 RTDWDD42 RTDWDD45 RTDWDD48

Increase the weight capacity of a rollout from 40Kg to 60Kg, by adding code: DWD-XL.



(705) 808-1038 Customer Service
(866) 376-4316 Fax

www.canadianacabinets.com

Components & Decorative J 11

ROLLOUTS

MELAMINE ROLLOUT 4 1/4" & 8" High

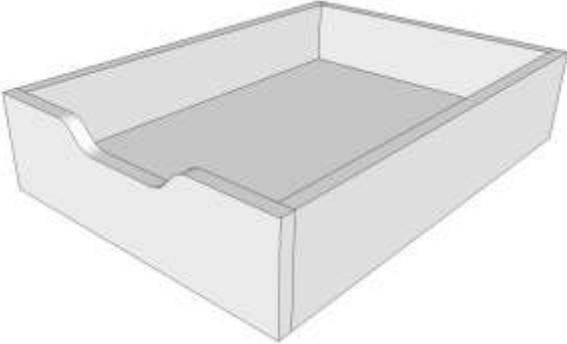
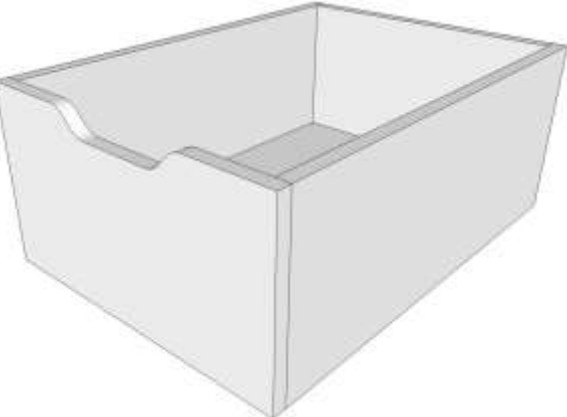
	SPECIAL CONSIDERATIONS: Factory installed, specify location-see page I3. Scooped Handle in Rollout Front Melamine Colour Matches Case (unless specified)	CODE	PRICE
	4 1/4" Rollout - 5/8" Melamine 40kg full extension soft close guides for cabinet size:	B09 RTMEL09 B12 RTMEL12 B15 RTMEL15 B18 RTMEL18 B21 RTMEL21 B24 RTMEL24 B27 RTMEL27 B30 RTMEL30 B33 RTMEL33 B36 RTMEL36 B39 RTMEL39 B42 RTMEL42 B45 RTMEL45 B48 RTMEL48	
	8" Rollout - 5/8" Melamine 40kg full extension soft close guides for cabinet size:	B09 RTMELD09 B12 RTMELD12 B15 RTMELD15 B18 RTMELD18 B21 RTMELD21 B24 RTMELD24 B27 RTMELD27 B30 RTMELD30 B33 RTMELD33 B36 RTMELD36 70 kg - B39 RTMELD39 70 kg - B42 RTMELD42 70 kg - B45 RTMELD45 70 kg - B48 RTMELD48	

© 2015 - 2020 Canadiana Cabinets Ltd | Revised August 2021

Increase the weight capacity of a Melamine Rollout from 40Kg to 70Kg, by adding code: DYNAPRO-XL.

Note: All 8" high Melamine Rollouts in cabinets 39" and larger use 70Kg slides as standard. Do not add charge to these drawers.





(705) 808-1038 Customer Service
(866) 376-4316 Fax

www.canadianacabinets.com

Components & Decorative J 12

ROLLOUTS

MAPLE PLYWOOD ROLLOUT 4 1/4" & 8" High			
	SPECIAL CONSIDERATIONS:	CODE	PRICE
	Factory installed, specify location-see page I3. Scooped Handle in Rollout Front		
	4 1/4" Rollout - 5/8" Maple Plywood 40kg full extension soft close guides for cabinet size:	B09 RTPD09 B12 RTPD12 B15 RTPD15 B18 RTPD18 B21 RTPD21 B24 RTPD24 B27 RTPD27 B30 RTPD30 B33 RTPD33 B36 RTPD36 B39 RTPD39 B42 RTPD42 B45 RTPD45 B48 RTPD48	
	8" Rollout - 5/8" Maple Plywood 40kg full extension soft close guides for cabinet size:	B09 RTPDD09 B12 RTPDD12 B15 RTPDD15 B18 RTPDD18 B21 RTPDD21 B24 RTPDD24 B27 RTPDD27 B30 RTPDD30 B33 RTPDD33 B36 RTPDD36 70 kg - B39 RTPDD39 70 kg - B42 RTPDD42 70 kg - B45 RTPDD45 70 kg - B48 RTPDD48	

© 2015 - 2020 Canadiana Cabinets Ltd | Revised August 2021



Increase the weight capacity of a Plywood Rollout from 40Kg to 70Kg, by adding code: DYNAPRO-XL.
Note: All 8" high Plywood Rollouts in cabinets 39" and larger use 70Kg slides as standard. Do not add charge to these drawers.

(705) 808-1038 Customer Service
 (866) 376-4316 Fax

www.canadianacabinets.com

Components & Decorative J 13

ROLLOUTS

SOLID MAPLE DOVETAIL ROLLOUT 4 1/4" & 8" High

	SPECIAL CONSIDERATIONS: Factory installed, specify location-see page I3. Scooped Handle in Rollout Front	CODE	PRICE
	<p>4 1/4" Rollout - 5/8" Solid Maple Dovetail 40kg full extension soft close guides for cabinet size:</p> <p><i>Minimum Dovetail Rollout Height is 2 1/2" high</i></p>	B09 RTWD09 B12 RTWD12 B15 RTWD15 B18 RTWD18 B21 RTWD21 B24 RTWD24 B27 RTWD27 B30 RTWD30 B33 RTWD33 B36 RTWD36 B39 RTWD39 B42 RTWD42 B45 RTWD45 B48 RTWD48	
	<p>8" Rollout - 5/8" Solid Maple Dovetail 40kg full extension soft close guides for cabinet size:</p>	B09 RTWDD09 B12 RTWDD12 B15 RTWDD15 B18 RTWDD18 B21 RTWDD21 B24 RTWDD24 B27 RTWDD27 B30 RTWDD30 B33 RTWDD33 B36 RTWDD36 70 kg - B39 RTWDD39 70 kg - B42 RTWDD42 70 kg - B45 RTWDD45 70 kg - B48 RTWDD48	

© 2015 - 2020 Canadiana Cabinets Ltd | Revised August 2021



Increase the weight capacity of a Dovetail Rollout from 40Kg to 70Kg, by adding code: DYNAPRO-XL.
Note: All 8" high Dovetail Rollouts in cabinets 39" and larger use 70Kg slides as standard. Do not add charge to these drawers.



(705) 808-1038 Customer Service
 (866) 376-4316 Fax

www.canadianacabinets.com

Components & Decorative J 14

ROLLOUTS

STAINED VENEER 5/8" ROLLOUT

	SPECIAL CONSIDERATIONS: Factory installed, specify location-see page I3. Scooped Handle in Rollout Front Wood Species and Colour to match kitchen Finish, unless specified	CODE	PRICE
	4 1/4" Rollout - 5/8" Stained Veneer 40kg full extension soft close guides for cabinet size:	B09 RTV09 B12 RTV12 B15 RTV15 B18 RTV18 B21 RTV21 B24 RTV24 B27 RTV27 B30 RTV30 B33 RTV33 B36 RTV36 B39 RTV39 B42 RTV42 B45 RTV45 B48 RTV48	
	8" Rollout - 5/8" Stained Veneer 40kg full extension soft close guides for cabinet size:	B09 RTVD09 B12 RTVD12 B15 RTVD15 B18 RTVD18 B21 RTVD21 B24 RTVD24 B27 RTVD27 B30 RTVD30 B33 RTVD33 B36 RTVD36 70 kg - B39 RTVD39 70 kg - B42 RTVD42 70 kg - B45 RTVD45 70 kg - B48 RTVD48	

© 2015 - 2020 Canadiana Cabinets Ltd | Revised August 2021

Increase the weight capacity of a Veneer Rollout from 40Kg to 70Kg, by adding code: DYNAPRO-XL.

Note: All 8" high Veneer Rollouts in cabinets 39" and larger use 70Kg slides as standard. Do not add charge to these drawers.



(705) 808-1038 Customer Service
(866) 376-4316 Fax

www.canadianacabinets.com

Components & Decorative J 15

ROLLOUTS

ROLLOUT SHELF 2" Thick

	SPECIAL CONSIDERATIONS:	CODE	PRICE
	<p>2" Thick Roll-out Shelf -40kg full extension soft close guides for:</p>	<p>B09 RS09 B12 RS12 B15 RS15 B18 RS18 B21 RS21 B24 RS24 B27 RS27 B30 RS30 B33 RS33 B36 RS36 B39 RS39 B42 RS42 B45 RS45 B48 RS48</p>	

Increase the weight capacity of a Rollout Shelf from 40Kg to 70Kg, by adding code: DYNAPRO-XL.



(705) 808-1038 Customer Service
 (866) 376-4316 Fax

www.canadianacabinets.com

Components & Decorative J 16

SHELVES

ADJUSTABLE MELAMINE SHELVES

	SPECIAL CONSIDERATIONS: 5/8" finished 2 long edges c/w steel shelf pins	CODE	
Upper	Shelves up to 24"w x 6 1/2"d	ADS6	Available in: White, Classic Maple & Canvas
	Shelves up to 45"w x 6 1/2"d	ADS6+	
	Shelves up to 24"w x 10 1/2"d	ADS12	
	Shelves up to 48"w x 10 1/2"d	ADS12+	
	Shelves up to 24"w x 13"d	ADS15	
	Shelves up to 45" w x 13"d	ADS15+	
Base	Shelves up to 24" w x 22"d	ADS24	
	Shelves up to 42" w x 22"d	ADS24+	
	Shelves up to 24"w x 13 1/2"d	ADBS13	
	Shelves up to 48"w x 13 1/2"d	ADBS13+	
	Shelves up to 24"w x 22 3/8"d	ADBS22	
Tall	Shelves up to 48"w x 22 3/8"d	ADBS22+	
	Note for 12" deep bases order standard upper shelf above		
	Shelves up to 24" w x 10 1/2"d	TSK12	
	Shelves up to 36" w x 10 1/2"d	TSK12+	
	Shelves up to 24" w x 16 3/4"d	TSK18	
	Shelves up to 36" w x 16 3/4"d	TSK18+	
	Shelves up to 24" w x 19 3/8"d	TSK21	
	Shelves up to 36" w x 19 3/8"d	TSK21+	
Shelves up to 24" w x 22 3/8"d	TSK24		
Shelves up to 36" w x 22 3/8"d	TSK24+		

ADJUSTABLE GLASS SHELVES (Upper)

SPECIAL CONSIDERATIONS: 6mm thick glass c/w 4 metal furniture shelf clips. Shelves wider than 30" require centre support.		CODE	PRICE
GLASS SHELVES Arris Edges on Sides (Broken Edge) Polished Front and Back (Rounded Edge)	<i>Priced Per Square Ft (1.5 Sq Ft Min)</i>		
Standard Cabinet Shelf	Name Thickness Clear 6 mm	SHELF-GL	

© 2015 - 2020 Canadiana Cabinets Ltd | Revised August 2021



(705) 808-1038 Customer Service
(866) 376-4316 Fax

www.canadianacabinets.com

Components & Decorative J 17

TRAY DIVIDERS



SPECIAL CONSIDERATIONS:

Available in the following materials:
 White Melamine - **DMI**
 Maple Melamine - **MM**
 Canvas Melamine - **CANVAS**
 Maple Plywood - **MPLY**

Tray Divider, 12"H Cabinet - 10 3/4"H x 20"D

CODE

TD12-DM1

PRICE

Tray Divider, 15"H Cabinet - 16 3/4"H x 20"D

TD15-DM1

Tray Divider, 18"H Cabinet - 16 3/4"H x 20"D

TD18-DM1

Tray Divider, 21"H Cabinet - 19 3/4"H x 20"D

TD21-DM1

Tray Divider, 24"H Cabinet - 22 3/4"H x 20"D

TD24-DM1

Tray Divider, 27"H Cabinet - 25 3/4"H x 20"D

TD27-DM1

CUTOUT DRAWER

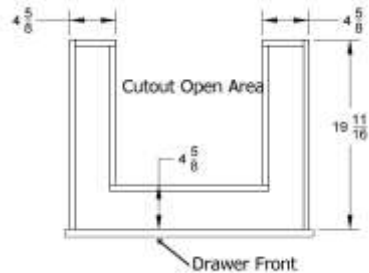

SPECIAL CONSIDERATIONS:

Cutout in centre of drawer box (each)

Add applicable Drawer Upgrades

Please Specify the Cutout Size

CODE

CODRAWER

PRICE



(705) 808-1038 Customer Service
 (866) 376-4316 Fax

www.canadianacabinets.com

Components & Decorative J 18

DECORATIVE STORAGE

UPPER PLATE RACK



SPECIAL CONSIDERATIONS:

Removable dowels | Can be installed in a 12" or 15" high upper. Installed.

				CODE	PRICE
	Plate rack installed in open case	30" wide	-Oak	PRI30-O	
			-Maple	PRI30-M	
			-Cherry	PRI30-C	
			-Paint	PRI30-Paint	
		36" wide	-Oak	PRI36-O	
			-Maple	PRI36-M	
			-Cherry	PRI36-C	
			-Paint	PRI36-Paint	

BOTTLE STORAGE SHELF



SPECIAL CONSIDERATIONS: Do not factor

Shelf replaces adjustable shelf in cabinet.

- * 1 1/8" deep
- * 2" diameter for back cutouts
- * 1" diameter on front cutouts
- * May be ordered to fit intermediate sizes order next size up and specify length

		CODE	PRICE
		BSS18-P	
		BSS18-O/M	
		BSS18-C/Paint	
		BSS24-P	
		BSS24-O/M	
		BSS24-C/Paint	
		BSS36-P	
		BSS36-O/M	
		BSS36-C/Paint	

STEMWARE STORAGE UNITS



SSU

SPECIAL CONSIDERATIONS : Attach to panel or bottom of shelf .
Shipped loose for site installation.

		CODE	PRICE
	Stemware storage unit 18" wide-	Pine	SSU18-O/P
		-Maple	SSU18-M
		-Cherry/Paint	SSU18-C/Paint
		-Pine	SSU36-P
		-Oak / Maple	SSU36-O/M
		-Cherry / Paint	SSU36-C/Paint



STORAGE SOLUTIONS

Lattice Wine Rack (11 ¹³/₁₆" deep)



Shown between two uppers
With optional stemware below.

SPECIAL CONSIDERATIONS: Do not factor - Not Available in Melamine & Thermofoil.

Includes a finished interior. Finished ends are an additional charge. Can be ordered 30" or 30 1/4" high. 30 1/4" high used in a base cabinet application. NO toe kick supplied.

Can be ordered 23 1/4" wide at no additional charge

*Can be ordered in heights up to 42".
Contact the Order Desk for pricing.*

	CODE	PRICE
Upper lattice Wine rack 12"w x 30"h Oak / Maple	ULWR1230-O/M	
Cherry / Paint	ULWR1230-C/Paint	
Upper lattice Wine rack 15"w x 30"h Oak / Maple	ULWR1530-O/M	
Cherry / Paint	ULWR1530-C/Paint	
Upper lattice Wine rack 18"w x 30"h Oak / Maple	ULWR1830-O/M	
Cherry / Paint	ULWR1830-C/Paint	
Upper lattice Wine rack 21"w x 30"h Oak / Maple	ULWR2130-O/M	
Cherry / Paint	ULWR2130-C/Paint	
Upper lattice Wine rack 24"w x 30"h Oak / Maple	ULWR2430-O/M	
Cherry / Paint	ULWR2430-C/Paint	



STORAGE SOLUTIONS

SPECIAL CONSIDERATIONS:

Can be ordered 30" or 30 1/4" high. 30 1/4" high used in a base cabinet application. NO toe kick supplied.

BOTTLE STORAGE (pigeon hole 11 13/16" deep)

6"w x 30"h x 11 13/16"d	BSU63012
9"w x 30"h x 11 13/16"d	BSU93012
12"w x 30"h x 11 13/16"d	BSU123012
15"w x 30"h x 11 13/16"d	BSU153012
18"w x 30"h x 11 13/16"d	BSU183012
21"w x 30"h x 11 13/16"d	BSU213012
24"w x 30"h x 11 13/16"d	BSU243012
6"w x 36"h x 11 13/16"d	BSU63612
9"w x 36"h x 11 13/16"d	BSU93612
12"w x 36"h x 11 13/16"d	BSU123612
15"w x 36"h x 11 13/16"d	BSU153612
18"w x 36"h x 11 13/16"d	BSU183612
21"w x 36"h x 11 13/16"d	BSU213612
24"w x 36"h x 11 13/16"d	BSU243612

Available in the following Materials/Species:

Maple, Oak, Knotty Pine, Cherry, Wormy Maple,
Painted, Designer Melamine 1, Designer Melamine 2,
Designer Melamine 3

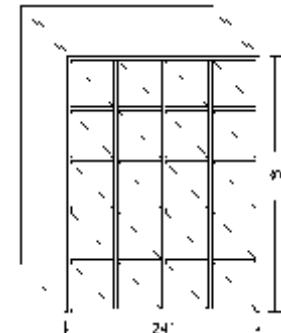
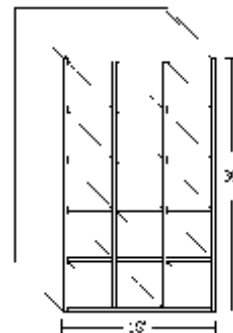
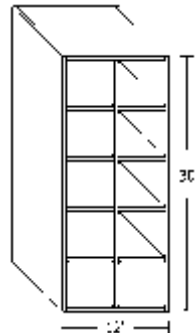
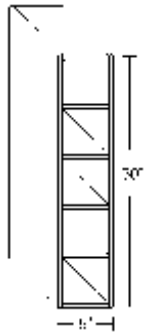

STORAGE SOLUTIONS



CORNER APPLIANCE GARAGE

 <p>Top rail 1 ¼" high</p> <p>1 ⅛" bottom rail</p>	SPECIAL CONSIDERATIONS: 18" high. May be trimmed to fit. Site assembly required.	CODE	PRICE
	24" x 24" Oak 24" x 24" Pine 24" x 24" Maple 24" x 24" Cherry 24" x 24" Paint **CAG24 cannot be reduced in width**	CAG24-O CAG24-P CAG24-M CAG24-C CAG24-Paint	

WALL APPLIANCE GARAGE

 <p>Top rail 1 ¼" high</p> <p>1 ⅛" bottom rail</p>	11 13/16" Deep	SPECIAL CONSIDERATIONS: 18" high. Height may be trimmed to fit.	CODE	PRICE
		24" Wide Oak 24" Wide Pine 24" Wide Maple 24" Wide Cherry 30" Wide Oak -Paint 30" Wide Pine 30" Wide Maple 30" Wide Cherry **WAG24 & 30 can be reduced in width**	WAG24-O WAG24-P WAG24-M WAG24-C WAG30-O WAG30-P WAG30-M WAG30-C	

SINK TRAY STORAGE

 	SPECIAL CONSIDERATIONS: Stainless Steel Tray with Soft Close Hinge Tip out Tray w/ Soft Close Hinges (Shipped Loose) Add /TO to Sink Base Code to include an installed Tip out Tray Tip Out Trays come in the following widths: 13", 18", 25", 31" <i>The largest size available will be installed into the sink base, unless otherwise specified.</i>	CODE	PRICE
		SBTO	

© 2015 - 2020 Canadiana Cabinets Ltd | Revised August 2021



(705) 808-1038 Customer Service
 (866) 376-4316 Fax

www.canadianacabinets.com

Components & Decorative J 22

LIGHTING

RECESS MOUNTED LED LIGHTS

Cabinet Interior & Under Cabinet Applications

CODE

PRICE



Available in Warm White (3000k)
and Cool White (4000k)

LED 2025, 12V, Warm White

LED2025-WARM

LED 2025, 12V, Cool White

LED2025-COOL

© 2015 - 2020 Canadiana Cabinets Ltd | Revised August 2021



LED Lighting Requires *Lights, Trim Kit, Lead and Driver.*
See *Lighting* in the J - SPECIFICATIONS section for complete system details and installation.

(705) 808-1038 Customer Service
(866) 376-4316 Fax

www.canadianacabinets.com

Components & Decorative J 23

LIGHTING

RECESS MOUNTED LED LIGHTS

Trim Covers

Trim Covers are required for LED Lights. Available in White, Silver, and Black.



Recess Trim Ring, White, *Round*
Recess Trim Ring, White, *Square*

LED2025-TRIM-WR
LED2025-TRIM-WS



Recess Trim Ring, Silver, *Round*
Recess Trim Ring, Silver, *Square*

LED2025-TRIM-SR
LED2025-TRIM-SS



Recess Trim Ring, Black, *Round*
Recess Trim Ring, Black, *Square*

LED2025-TRIM-BR
LED2025-TRIM-BS

© 2015 - 2020 Canadiana Cabinets Ltd | Revised August 2021



LED Lighting Requires *Lights, Trim Kit, Lead and Driver.*
See *Lighting* in the J - SPECIFICATIONS section for complete system details and installation.



(705) 808-1038 Customer Service
(866) 376-4316 Fax

www.canadianacabinets.com

Components & Decorative J 24

LIGHTING

RECESS MOUNTED LED LIGHTS

	CODE	PRICE
<p>12V DRIVER The size of driver required, is calculated from the total wattage of lights powered by the driver. The lights used in this system are approximately 4 watts each. If unsure of which driver would be required, please contact customer service.</p>  <p>LED 12V Driver, 0-20W LED 12V Driver, 0-40W LED 12V Driver, 0-60W</p>	<p>LED12DRIVER-20W LED12DRIVER-40W LED12DRIVER-60W</p>	
<p>LED LEAD The LED Lead connects the LED light to the driver. It is available in 3 lengths.</p>  <p>LED Lead, 500mm (19 5/8") LED Lead, 1000mm (39 3/8") LED Lead, 2000mm (78 3/4")</p>	<p>LED12LEAD-500 LED12LEAD-1000 LED12LEAD-2000</p>	
<p>LED LEAD EXTENSION The LED Lead Extension is used when the distance from the LED to the Driver is longer than 2000mm (78 3/4"). This is used in addition to the LED lead, and not as a replacement. There is no limit on the length of extensions used.</p>  <p>LED Lead Extension, 500mm (19 5/8") LED Lead Extension, 1000mm (39 3/8") LED Lead Extension, 2000mm (78 3/4")</p>	<p>LED12EXT-500 LED12EXT-1000 LED12EXT-2000</p>	

© 2015 - 2020 Canadiana Cabinets Ltd | Revised August 2021



LED Lighting Requires *Lights, Trim Kit, Lead and Driver.*
See *Lighting* in the J - SPECIFICATIONS section for complete system details and installation.

(705) 808-1038 Customer Service
(866) 376-4316 Fax

www.canadianacabinets.com

Components & Decorative J 25

INSTALLATION SUPPLIES (Misc.)		
SPECIAL CONSIDERATIONS: All Edge Tapes are Veneer or PVC (No Glue)	CODE	PRICE
Edge tape PVC 15/16" x length state colour (per ft.) Edge tape Veneer 15/16" x length state wood species & colour (per ft.) Edge tape Veneer 1 1/2" x length unfinished state wood species (per ft.) Glass shelf clip (5mm) (clear plastic with metal peg) package of 25 Steel Shelf Pin (5mm) Clear Rubber Bumper pads 200 per card L Brackets 90 degree 3/4" x 3/4" metal package of 25 Fast Caps (1/2 Sheet) 26 caps–Cherry, Maple, Oak & Pine order as FASTCAPS-O Fast Caps (1/2 Sheet) 26 caps–Melamine –Available in White, Grey, Almond & Black Fast Caps (1/2 Sheet) 26 caps–Maple Melamine	ET-PVC ET-V ET1.5-V FSHELF CLIPS SHELF CLIPS BUMPONS LBRACKETS FASTCAPS- FASTCAPS-MEL FASTCAPS-MM	



(705) 808-1038 Customer Service
 (866) 376-4316 Fax

www.canadianacabinets.com

Components & Decorative J 26

RANGE HOODS

CANADIANA RANGE HOOD

11 13/16" d

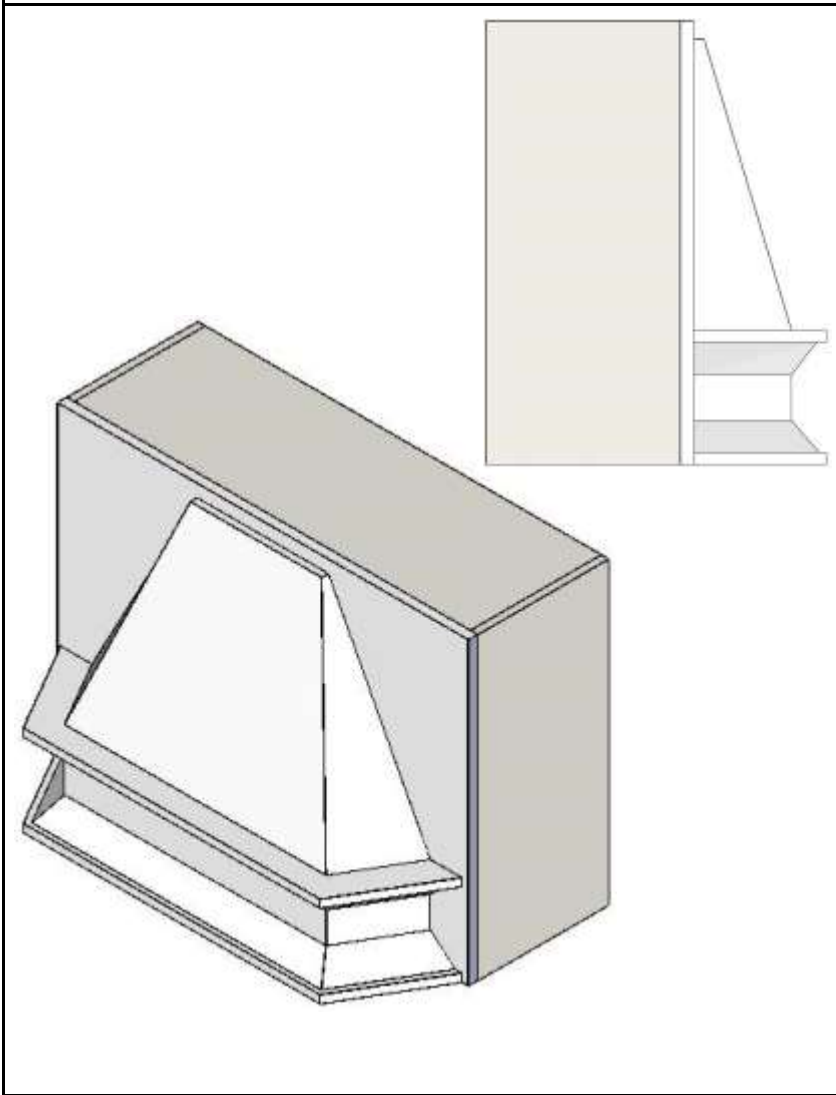

SPECIAL CONSIDERATIONS	CODE	PINE	MAPLE OAK	CHERRY PAINT WMAPLE
<ul style="list-style-type: none"> ◆ DO NOT FACTOR ◆ Liner or fan not included ◆ Case can be up to 30" <p>Cyclone Hood Inserts Available</p>	<p>CDRH3024 CDRH3124 CDRH3624</p> <p>CDRH3030 CDRH3130 CDRH3630</p>			

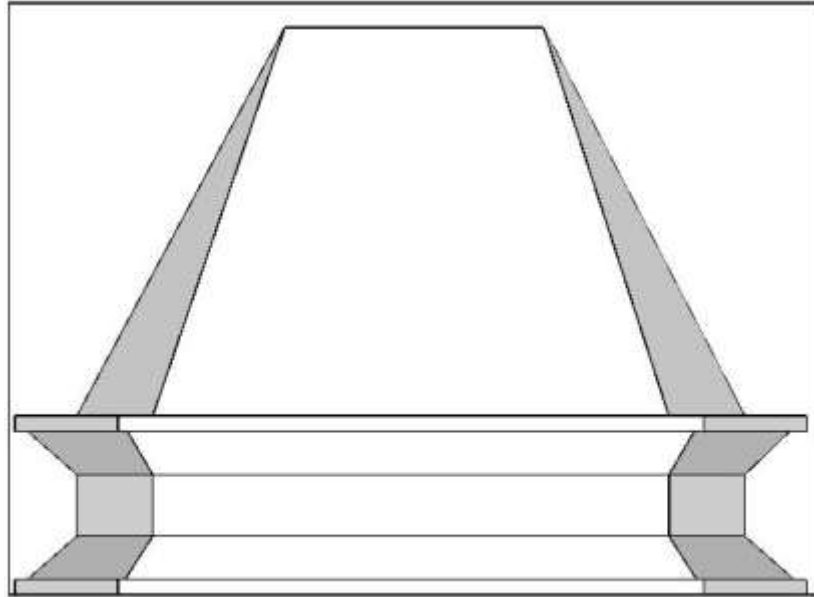

© 2015 - 2020 Canadiana Cabinets Ltd | Revised August 2021



(705) 808-1038 Customer Service
(866) 376-4316 Fax

www.canadianacabinets.com

Components & Decorative J 27

RANGE HOODS

SHAKER RANGE HOOD

11 13/16" d

SPECIAL CONSIDERATIONS

- ◆ **DO NOT FACTOR**
- ◆ Liner or fan not included
- ◆ Case can be up to 30"

Cyclone Hood Inserts Available

CODE

SRH30
SRH31
SRH36

PINE

MAPLE
OAK

CHERRY
PAINT
WMAPE

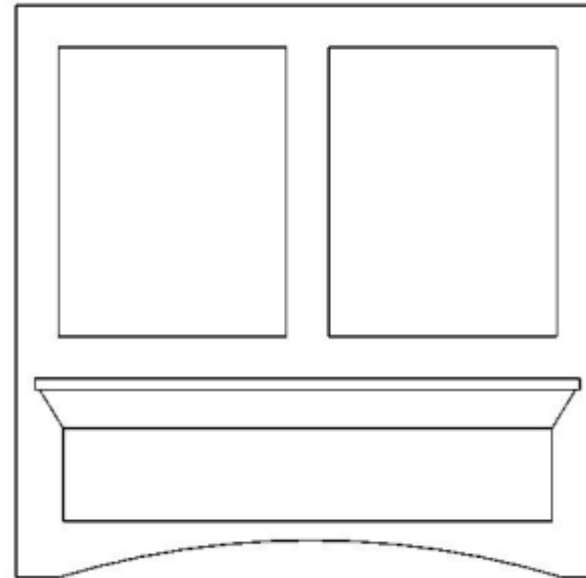
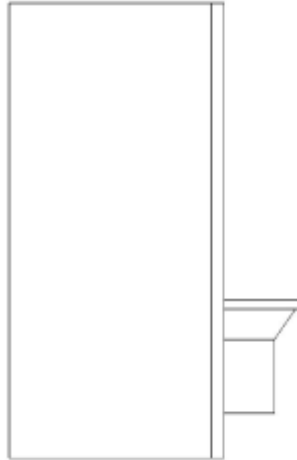
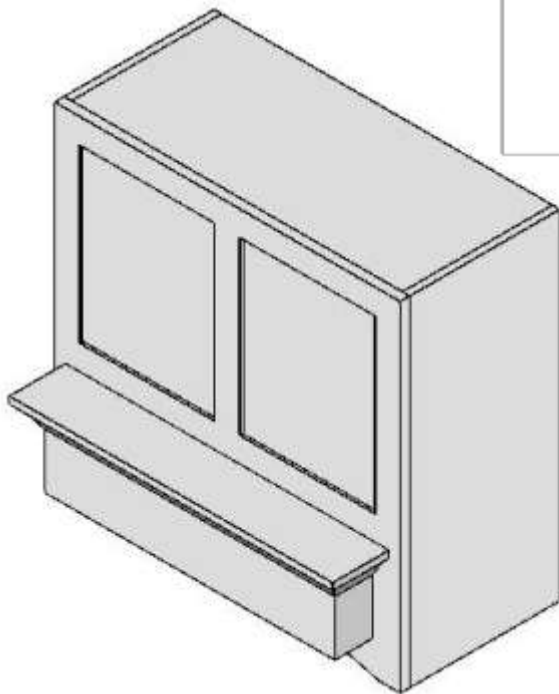

© 2015 - 2020 Canadiana Cabinets Ltd | Revised August 2021



(705) 808-1038 Customer Service
(866) 376-4316 Fax

www.canadianacabinets.com

Components & Decorative J 28

RANGE HOODS

HOOD FAN INSERT

	CODE	PRICE
Cyclone Stainless BX215 26.5"W x 10.25"D 6" round duct 550 CFM Mesh Filters	BX21528	
Cyclone Stainless BX600 26.5"W x 10.25"D Stainless Steel Baffle Filters 6" round duct 600 CFM	BX60028	



BX215



BX600

© 2015 - 2020 Canadiana Cabinets Ltd | Revised August 2021



(705) 808-1038 Customer Service
 (866) 376-4316 Fax

www.canadianacabinets.com

Components & Decorative J 29